

Grooved End Connection

Series D "9D" Nickel Aluminum Bronze

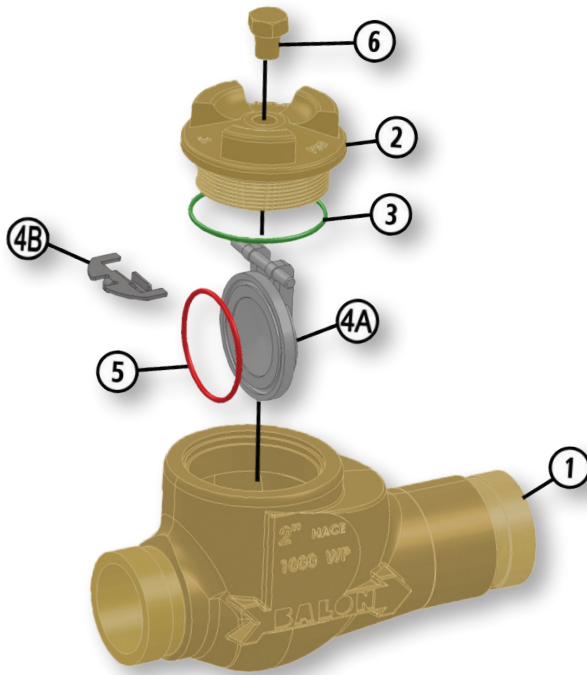

- 100% Made in USA
- Top Entry Swing Check Valve
- 1000 PSI WP
- 2" Through 6"
- ASTM B148 GR 955 "9D"
- Threaded Body Construction
- NACE Standard
 - Enhanced Protection Against CO₂ and Saltwater Corrosion
 - Replaceable 316 Stainless Steel Seat Disc Cartridge Standard
 - Exceptional Yield Strength
 - Improved by Design for Easier Bonnet Removal
 - Fully Machined Grooves



Material Description

ITEM	PART NAME	DESCRIPTION
1	Body	ASTM B148 GR 955
2	Bonnet	ASTM B148 GR 955
3	Bonnet Seal	Fluorocarbon
4A	Disc	Replaceable 316 Stainless Steel
4B	Disc Hanger	316 Stainless Steel
5	Disc Seal	Fluorocarbon
6	Pipe Plug	316 Stainless Steel

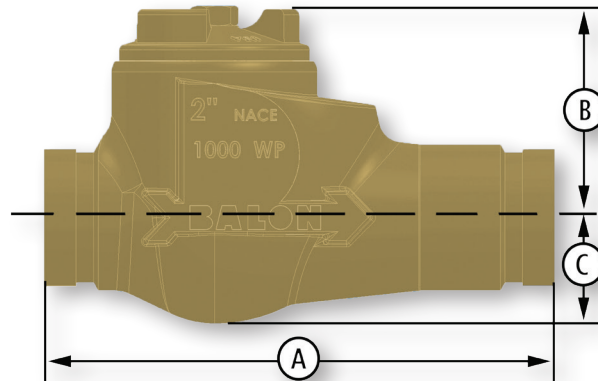

Dimensional Data

SIZE	CATALOG	PORT	WP	A	B	C	LBS.
2	2F-D44-GE	2	1000	9.00	3.58	1.82	9.75
3	3F-D44-GE	3	1000	10.75	4.50	2.45	21.00
4	4F-D44-GE	4	1000	12.00	5.54	2.95	36.00
6	6R-D44-GE	4	1000	12.00	5.54	2.95	38.6