

Grooved End Connection

Series S Ductile Iron

- 100% Made in USA
- To 1000 PSI WP
- 2" Through 6"
- Threaded Body Construction
 - Certified Low Emission Per API 641
 - Fire Safe Design
 - NACE Option With 316 Stainless Steel Ball and Stem Available
 - High Grade Annealed Ductile Iron for Better Corrosion Resistance and Greater Yield Strength
 - Rugged Locking Device Standard
 - Multi-Seal Seats (See page B-5)



Material Description

ITEM	PART NAME	MATERIAL (STANDARD)	MATERIAL (NACE)
1	Handle*	Carbon Steel/Ductile Iron	Carbon Steel/Ductile Iron
2	Handle Bolt	Standard Hex Bolt	Standard Hex Bolt
3	Weather Guard	Polypropylene	Polypropylene
4	Lock Plate Retainer	Carbon Spring Steel	Carbon Spring Steel
5	Lock Plate	Carbon Steel	Carbon Steel
6	Dust Cover	Polypropylene	Polypropylene
7	Stop Plate Retainer	Carbon Spring Steel	Carbon Spring Steel
8	Stop Plate	Carbon Steel	Carbon Steel
9	Stem O-Ring	Buna-N	Fluorocarbon
10	Stem Seal	TFE	TFE
11	Stem	Carbon Steel	316 Stainless Steel
12	Ball	Carbon Steel Nickel Chrome Plated	316 Stainless Steel
13	Ball Seat	Nylon 11 (TFE Optional**)	Nylon 11 (TFE Optional**)
14	Body O-Ring	Buna-N	Fluorocarbon
15	End Adapter	ASTM A395 Class 60-40-18 Fully Annealed	ASTM A395 Class 60-40-18 Fully Annealed
16	Body	ASTM A395 Class 60-40-18 Fully Annealed	ASTM A395 Class 60-40-18 Fully Annealed

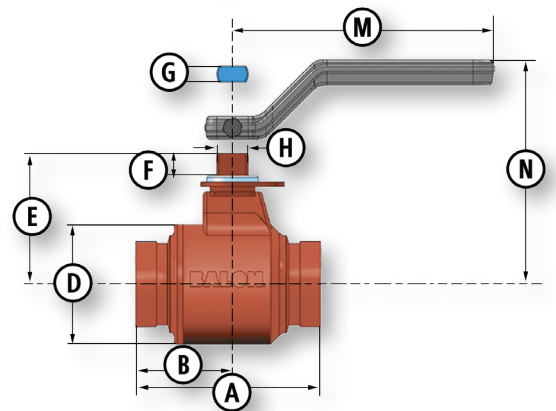
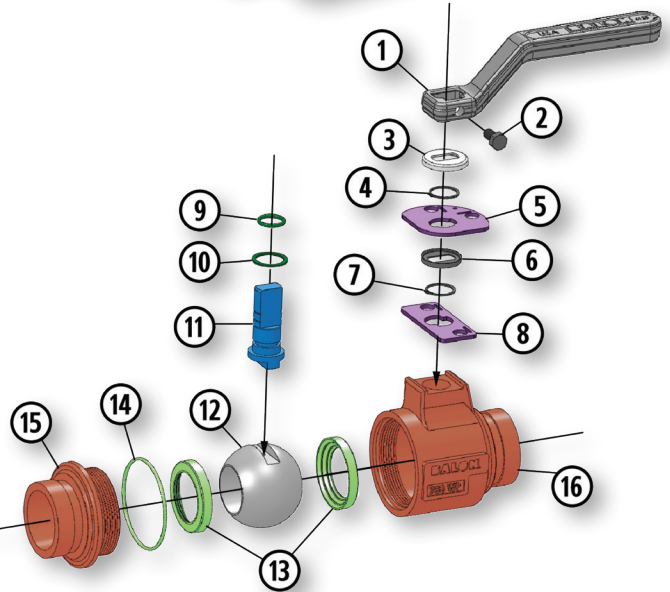

* Handle is optional. Balon valves can also be operated with a standard open-end wrench.
 ** Seat selection may result in de-rating of pressure. See Seat Pressure Ratings chart on page TD-4 for more information.

Dimensional Data

SIZE	CATALOG NUMBER		PORT	WP	A	B	D	E	F	G	H	M	N	LBS.	HANDLE	Cv
	STANDARD TRIM CARBON STEEL BALL & STEM	NACE TRIM 316 SS BALL & STEM														
2x1.5x2	2R-S32-GE	2R-S32N-GE	1.5	750	5.12	2.68	3.37	3.62	0.62	.434	0.873	7.25	5.25	7.5	P-4128-CS	140
2x2x2	2F-S32-GE	2F-S32N-GE	2.0	750	6.00	3.12	4.25	4.37	0.75	.497	0.998	10.25	6.20	12.0	P-4129-CS	-
3x2x3	3R-S32-GE	3R-S32N-GE	2.0	750	7.25	3.50	4.50	4.37	0.75	.497	0.998	10.25	6.20	17.0	P-4129-CS	200
3x3x3	3F-S32-GE	3F-S32N-GE	3.0	750	7.25	3.75	6.00	5.75	0.87	.747	1.373	20.00	7.75	31.0	P-4127-DI	-
4x3x4	4R-S32-GE	4R-S32N-GE	3.0	750	8.87	4.50	6.00	5.75	0.87	.747	1.373	20.00	7.75	34.0	P-4127-DI	550
4x4x4	4F-S22-GE	4F-S22N-GE	4.0	500	8.87	4.50	7.50	6.37	1.06	.747	1.373	20.00	8.37	49.0	P-4127-DI	-
6x4x6	6R-S22-GE	6R-S22N-GE	4.0	500	10.10	5.05	7.00	6.38	0.87	.747	1.373	20.00	8.38	57.0	P-4127-DI	800

Balon manufactured Actuation Mounting Hardware available. Please see page A-2 for details.